

# Krishna Hills

Affordable  
UIT Converted plots



For more details

Call us on +91 88755 33888, +91 93512 38887



Lush Green Property



International Cricket Ground

Umarda Hitech Railway Station

**KHASRA PLAN**  
**SCALE: 1CM = 40 MT**

TOTAL AREA: 2.3 HECT.  
TOTAL AREA-247840.59 SQFT. (100.00%)  
PLOT AREA-162495.00 SQFT. (65.59%)  
KISSAN AREA-6100.00 SQFT. (02.52%)  
ROAD AREA-79127.7593 SQFT. (31.90%)

**For more details Call us on +91 88755 33888, +91 93512 38887**

## HIGHLIGHTS OF PLAN

- 1. Lush Plantation:** The villa property is surrounded by a beautiful plantation that adds to the charm and serenity of the location.
- 2. Secure Wire Fencing:** The property is enclosed with robust wire fencing that ensures round-the-clock security and privacy to the residents.
- 3. Durable Concrete Road:** The villa boasts of a 9-inch concrete road that adds to its sturdiness and durability.
- 4. Efficient Sewage System:** The property is equipped with a modern sewage system that ensures proper disposal of waste and sanitation.





- 300 METRE RAILWAY STATION
- INTERNATIONAL STADIUM
- UIT CONVERTED PLOTS
- GATED COLONY
- LUSH GREEN PROPERTY

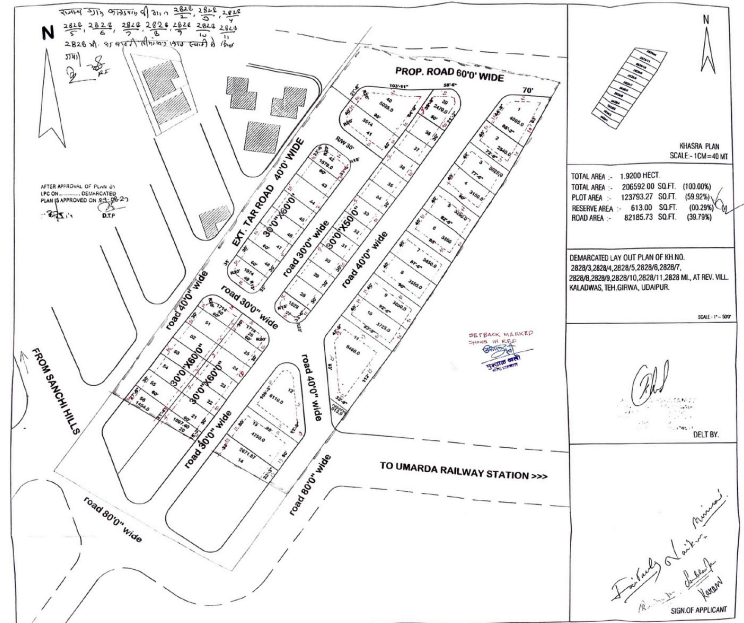
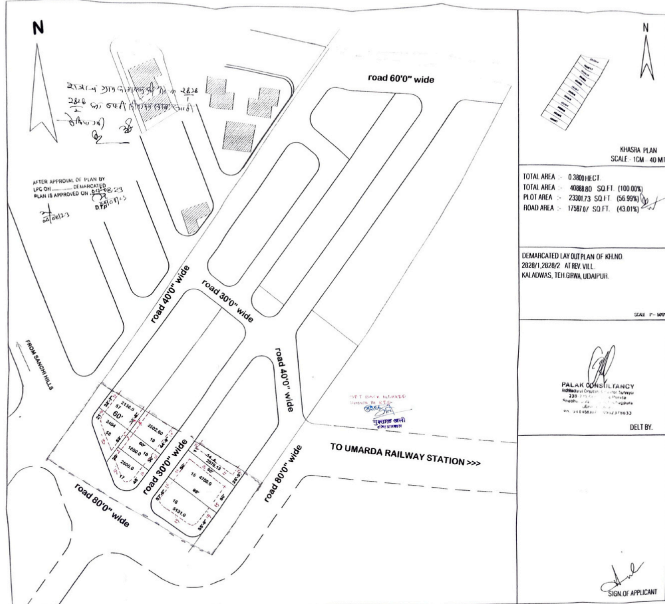

## NEAR BY FACILITIES

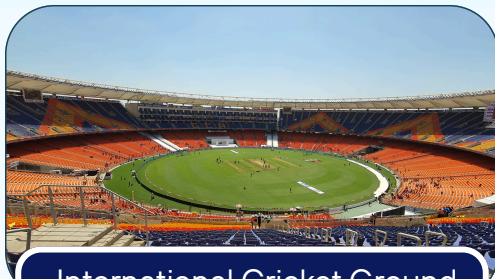

International Cricket Ground

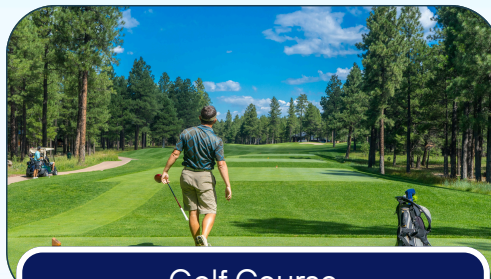

Golf Course



Umarda Railway Station



Six Lane Highway



Fuel Stations



Restaurants



Hospitals



Banks & ATM



Education Hub

For more details Call us on +91 88755 33888, +91 93512 38887



- कॉर्नर प्लॉट उपलब्ध
- गेटेड कॉलोनी
- रोड साइज 30, 40, 60 एवं 80 Ft.

## SITE PLAN LOCATION

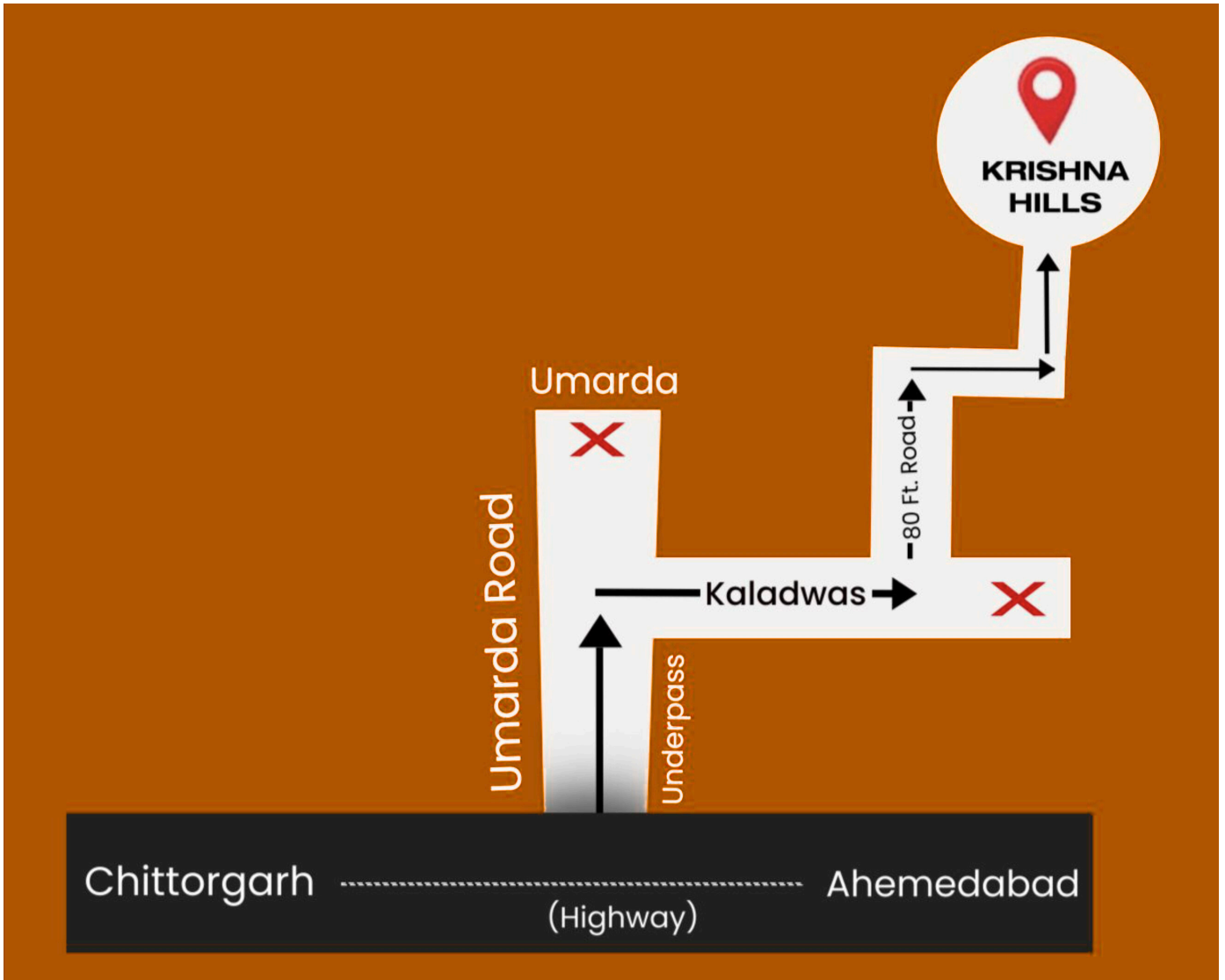

**Location: Vill. Kaladwas, The Girwa, Udaipur – 313003**

## Get in Touch Today

+91 88755 33888, +91 93512 38887

realestate@18colours.com

www.18colours.com/realestate



Scan to see location